

**52nd Annual Meeting
Southwestern Chapter, SNM
March 30 - April 1, 2007**

**Renaissance Worthington
Sundance Square, Fort Worth, Texas**



Exhibitor Prospectus

An attractive venue and hundreds of great clients await you!

Apply now! Booth space is limited.

For updates, browse:

www.swcsnm.org/meetings/2007mtg.htm

Southwestern Chapter of the Society of Nuclear Medicine

Dear Exhibitor:

We invite you to come exhibit at next year's 52nd Annual Meeting. Our meeting will be held March 30 - April 1, 2007 at the Renaissance Worthington--a Four-Diamond Award hotel in Sundance Square, Fort Worth, Texas. We anticipate 650 or more registrants. We had this many in San Antonio (2005) and are hoping to exceed this number for 2007 because:

- We will have another strong educational program. We plan to bring in high-quality, nationally-recognized speakers from outside and within the Chapter.
- Fort Worth is easily accessible to everyone in our Chapter and outside of the Chapter.
- Sundance Square is a beautiful location for a meeting—many restaurants, entertainment and shopping options all within easy walking distance. It's all we look for in a meeting locale, and the Worthington has more than enough space and has recently been upgraded with nearly \$8 million dollars in renovations.
- We have meeting momentum. With recent meetings having been so well attended, we have maintained a growing database of nuclear medicine professionals, and send to other organization lists, too.

Your support is important. Corporate representatives have proven to be excellent promoters of our meetings, once they are convinced of the quality of the education and attendees. Please begin planning to provide an educational grant to the SW Chapter. We need more than your promotional support. Your generous grant can prove critical for meeting success.

Sincerely,

Michael Brophey, MD and David Blea, CNMT, 52nd Annual Meeting Co-Chairs

Attendance Profiles

City	Albuquerque	S. Antonio	Austin	OK City	Galveston	N. Orleans	Galveston	Santa Fe
Year	2006	2005	2004	2003	2002	2001	2000	1999
Physician Total	64	112	108	81	117	95	74	83
Technologist Total	343	546	453	297	384	315	345	173
Attendee Total	407	658	561	378	501	410	419	256
Exhibit Staff	103	110	95	85	89	79	92	90

List of Exhibitors at our 51st Annual Meeting, April 7-9, 2006

Alliance Imaging	Cytogen Corporation	Numed, Inc.
AnazaHealth Corp	Daxor Corporation	PETNET Solutions
Astellas Pharma US	Digirad	Philips Medical Systems.
Biodex Medical Systems	DMS Imaging	Pinestar Technology, Inc.
Biodose	Eastern Isotopes / IBA	Scientific Imaging
Biogen Idec	GE Healthcare	Siemens Medical Solutions
Biotech Pharmacy	Genzyme Corp.	Southwestern Imaging Systems & Svcs
Bracco Diagnostics, Inc.	ISO-Tex Diagnostics, Inc.	Technology Imaging Services
Bristol-Myers Squibb Medical Imaging	Mallinckrodt	The Gollman Group, Inc.
Capintec, Inc.	MIMvista Corp.	Universal Medical Resources, Inc.
Cardinal Health Nuclear Pharmacy	Nuclear Imaging Services	US Army Healthcare
Cyclotope		

Exhibition Details

Exhibition Dates and Hours

Exhibit hours, subject to changes authorized by the Southwestern Chapter, SNM, are:

Friday, March 30, 10:00 a.m. - 7:00 p.m.

Saturday, March 31, 8:00 a.m. - 4:00 p.m.

In addition to the customary Friday evening reception and 30-minute beverage breaks, gift raffles will also be held to encourage exhibition attendance.

Exhibit Booth Specifications

Booths 1-14 and 27-28 will be **10-foot by 10-foot booths**. Remaining booths will be **10-foot wide by 9-foot deep** to provide enough aisle space (**the image below is not quite to scale**). All booths will have 8-foot high backwall drape and 3-foot siderail drape. The Chapter will supply a 7-inch by 44-inch identification sign for each booth. Security guard service and aisle cleaning will also be provided without additional charge.

Exhibition Floor Plan

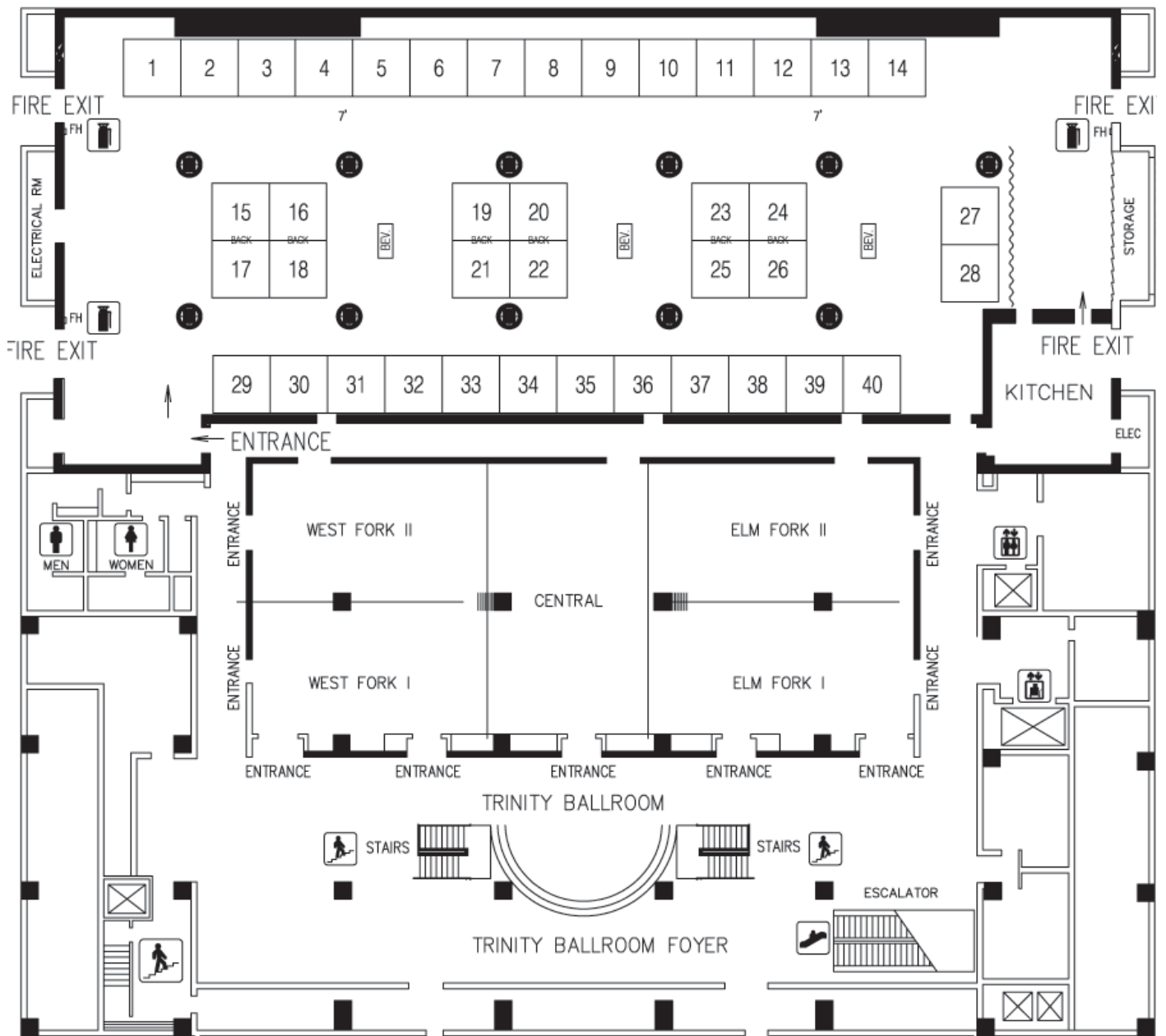

Additional Exhibition Details

Cost of Space

The price for each booth is \$1,250. This price includes badges for four personnel, beverage breaks, a reception in the exhibit hall, and items previously detailed under the heading entitled, "Exhibit Booth Specifications."

Installation and Dismantling

The exhibit hall will be ready for set-up and installation at 12:00 Noon on Thursday, March 29, 2007. It is the responsibility of each exhibitor to have their booth erected. All work must be completed by 9:00 p.m. Thursday for inspection.

Exhibitors may not dismantle nor do any packing before 4:00 p.m. on Saturday, March 31. All exhibit material must be removed from the exhibit hall by 8:00 p.m. on Saturday. The drayage and storage contractor for the meeting reserves the right to ship (freight collect) packages, cartons, crates, etc. left in the exhibit hall beyond the cutoff time, unless special contract arrangements are agreed upon by the exhibitor and the contractor.

Application for Space

Exhibit space assignments will be based on the date when the signed contract is received in the Chapter office, accompanied by a 50% deposit of the booth fee. Additionally, when space preference conflicts exist, the Chapter will attempt to assign space fairly and at its own discretion. Space assignment will be held for the exhibitor for thirty days after invoicing pending receipt of full payment. Thereafter, if payment is not received, the Chapter may cancel the application and reassign the space. Should the exhibitor cancel after the notice of assignment is mailed, the Chapter may reassign the space and all rental paid by the exhibitor may be retained by the Chapter as liquidation charges.

Exhibit Registration

Admission to the Exhibit Hall for exhibitors and attendees is by badge only. It will be the responsibility of each exhibiting company to provide an accurate listing of representatives who will be present. Badges will be prepared in advance only for those individuals. Official badges for exhibitors will be limited to four for each booth. Additional badges will be \$100 each.

Official Decorator & Drayage Contractor

FREEMAN

8801 Ambassador Row

Dallas, TX 75247

Telephone: 214-634-1463

Email: freemandallases@freemanco.com

Security and Liability

Professional security guard service will be provided during non-exhibit hours. Each party involved in the exhibit: hotel, exhibitor, leasing association agrees to be responsible for their own negligence or that of their employees or agents. Each party agrees to be responsible for their own property through insurance or self-insurance and shall hold harmless each of the other parties for any and all damages caused by theft and those perils normally covered by fire and extended coverage policy.

Rules for Exhibition

No booth or display material may exceed the height of 8 feet. All aisles must be kept clear to conform to fire regulations. There may be no spans over the aisles. Exhibits not conforming to these specifications or which in design, operation, or otherwise are objectionable in the opinion of the Chapter President will be prohibited.

Canvassing in any part of the exhibit or meeting rooms by anyone representing or connected with a non-exhibiting firm is strictly forbidden. Canvassing or distributing advertising material by the exhibitor will not be permitted outside the exhibitor's allotted space.

No exhibition shall assign, sublet or share the whole or any part of the space allotted without the knowledge or consent of the Chapter President.

The Chapter reserves the right to restrict exhibits, which for any reason become objectionable and also to prohibit or evict any exhibit that in their opinion may detract from the general character of the exhibition. This reservation includes persons, or things, conduct, printed matter or anything of a character which may be objectionable for the exhibition as a whole. In the event of such restriction or eviction, the Chapter will, not be liable for any refunds of rentals or exhibit expense.

Application for Exhibit Space

Application for exhibit space at the 52nd Annual Scientific Meeting of the Southwestern Chapter, Society of Nuclear Medicine indicates the applicant's willingness to abide by all accompanying exhibit terms and conditions and general regulations as well as additional, rules and regulations as the Chapter deems necessary to the success of the exhibition, provided these latter do not materially alter the exhibitor's contractual rights. If all choices of space have been allocated, the Chapter will assign what is considered best of available space.

(Please Type or Print)

Firm Name _____

Contact (person to whom space assignment service kit and invoice should be sent):

Name _____ Title _____

Mailing Address _____

City _____ State _____ Zip _____

Telephone _____ Email _____

We would prefer, if possible, that our company *NOT* be located near the following companies:

We would prefer, if possible, that our company *BE* located near the following companies:

We prefer the following locations:

1st Choice: Booth No. _____ 2nd Choice: Booth No. _____ 3rd Choice: Booth No. _____

Booth price is \$1,250. Enclosed is our payment of \$ _____ (Minimum of 50% deposit).

Name of Firm (as you want it to show on the standard 7" x 44" identification sign):

Included in the cost of your space is a free write-up (limited to 50 words) of your products, equipment, or services. This information will be included in the Final Program that is distributed to all attendees. **Please take the time to submit your description now.**

A Description of What We Will Display-(50 words or less; please type)

Authorized Signature _____ Date _____

Application should be signed and mailed to: Charles Metzger, Executive Director Southwestern Chapter, SNM, 910 Pecan Street, Kerrville, TX 78028-3054, Ph: 830-257-0112 Fax: 830-257-0119 Email: cmetzger@swcsnm.org

Please make checks payable to Southwestern Chapter Society of Nuclear Medicine Tax ID #75-1189350

Educational Grants and Event Sponsorships

By providing an educational grant or event sponsorship, your company can gain added recognition at our 52nd Annual Meeting. Opportunities and the levels of recognition are listed below.

Checks do not need to be returned with the application. The application can be submitted as a notice of intent. We will send an ACCME sponsor agreement form as soon as we receive your application.

_____ **Platinum Level Educational Grant:** Minimum \$5,000 educational grant
Recognition: Sign in registration area, emphasized company acknowledgment in the Final Program, and recognition banner for Exhibit Booth.

_____ **Gold Level Educational Grant:** Minimum \$3,500 educational grant
Recognition: Sign in registration area and emphasized company acknowledgment in the Final Program.

_____ **Silver Level Educational Grant:** \$2,000 educational grant **This level of support covers the cost of bringing an out-of-Chapter speaker to the meeting.*
Recognition: Sign in registration area and company acknowledgment in the Final Program.

_____ **Bronze Level Educational Grant:** Minimum \$500 educational grant
Recognition: Company acknowledgment in the Final Program.

_____ **Coffee Break Sponsorship:** \$5,000 total
Recognition: Multiple signs near refreshment tables and acknowledgment in the Final Program.

_____ **Partial Coffee Break Sponsorship:** \$1,000 for one break
Recognition: Sign near refreshment tables and acknowledgment in the Final Program.

Name _____ Title _____

Firm Name _____

Mailing Address _____

City _____ State _____ Zip _____

Telephone _____ Email _____

Please make checks payable to Southwestern Chapter of the Society of Nuclear Medicine (Tax ID #75-1189350)

Application should be signed and mailed to: Charles Metzger, Executive Director Southwestern Chapter, SNM, 910 Pecan Street, Kerrville, TX 78028-3054, Ph: 830-257-0112 Fax: 830-257-0119 Email: cmetzger@swcsnm.org

Preliminary Program Details

Program Co-Chairs Michael Brophay, MD and David Blea, CNMT have developed an excellent program designed for nuclear medicine physicians, technologists, pharmacists, radiologists, oncologists, and scientists involved in the field of Nuclear Medicine. Individuals attending the course of lectures will be able to:

1. Review essential protocols involved in general nuclear medicine procedures, including brain and renovascular
2. Describe the latest applications of PET with an emphasis on cross-sectional anatomy correlation
3. Review integrated and other cardiac imaging techniques
4. Restate vital personal and inter-relational skills in the Nuclear Medicine workplace

Preliminary, *Incomplete* Program Schedule

Friday, March 30, 2007

Renovascular Hypertension, Kenneth Johnson, MD

Patient and Co-Worker Diversity in Healthcare, Janet Champagne, MS, CNMT

Brain Imaging, Dana Mathews, PhD, MD

History of Nuclear Laboratory Accreditation, Terence Bevens, MD

Real PET Imaging (Veterinarian's Perspective), Brian Poteet, DVM

Stress Out!! Nancy Burchell, CNMT

SPECT/CT: Current State of the Art, William Erwin, MS

The SNM and Molecular Imaging, Michael Devous, PhD

Saturday, March 31, 2007

PET & Therapy at MD Anderson Cancer Center, Donald Podoloff, MD

PET & Diagnosis at MD Anderson Cancer Center, Homer Macapinlac, MD

PET Management at MD Anderson Cancer Center, Nancy Swanston, CNMT

CT Correlation to PET, Eric Rohren MD, PhD

PET/CT Artifacts, F. Cesani, MD

Maintenance of Certification, Henry Royal, MD

Seizure Imaging with PET and SPECT, Dana Mathews, PhD, MD

Nuclear Pharmacy Regulations and Q.C. with Cyclotron, Leroy Candelaria

Alternative Imaging with Common Isotopes, TBD

Sunday, April 1, 2007

Integrated Cardiac Imaging, Jeffery Schussler, MD

Cardiac Imaging: Pumped for the Future, April Mann, CNMT

One or Two-Day Protocols for Cardiac Imaging, David Blea, CNMT

Continuing Education Information

This activity has been planned and implemented in accordance with the Essentials and Standards of the Accreditation Council for Continuing Medical Education through the joint sponsorship of the Society of Nuclear Medicine (SNM) and the SW Chapter, SNM. The SNM is accredited by the ACCME to provide continuing medical education for physicians.